

# INUA 7240

72" x 40" x 23"

In Inuit spirituality Inua means "everything that lives." INUA is the universal soul that unites all things in nature.

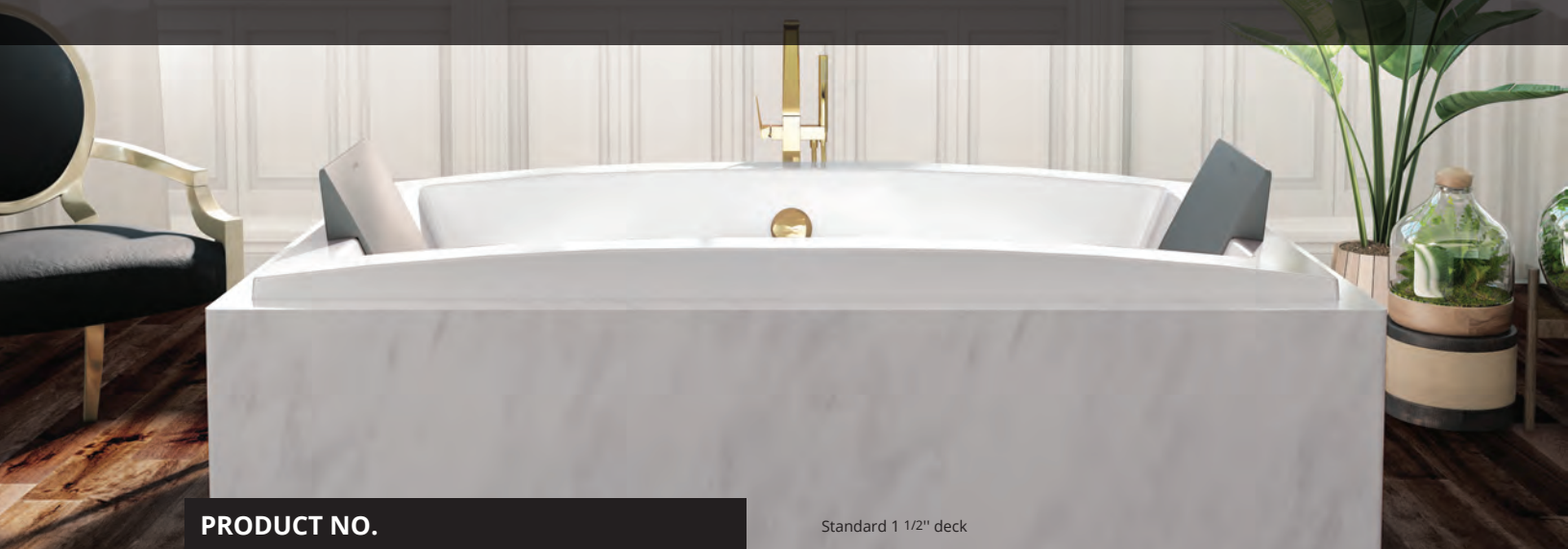

## PRODUCT NO.

Standard 1 1/2" deck

| MODEL                | TMU          | TUB          |
|----------------------|--------------|--------------|
| Standard 1 1/2" deck | BINURD00T-XX | BINURD00N-XX |
| Slim deck 1/2"       | BINURD10T-XX | BINURD10N-XX |

| THERMOMASSEUR (TMU)                               |          |
|---|----------|
| Hydro-thermo massage • Air jet system             | \$       |
| Jets  | 58       |
| 1 heated backrest                                 | Included |
| MiaPlus® Control                                  | Included |
| BU-Touch Control Application BUTOUCH              | \$       |
| Geysair®  | Included |
| AromaCloud® BAROMAC                               | \$       |
| Illuzio Chromatherapy BCHRO6                      | \$       |
| 2 <sup>nd</sup> heated backrest (WTS-1 zone) BSHB | \$       |

| TUB                                   |                       |
|---------------------------------------|-----------------------|
| Soaker                                | \$                    |
| AromaCloud® BAROMAC                   | \$                    |
| Illuzio Chromatherapy BCHRO6          | \$                    |
| WarmTouchShell® BWTS                  | \$                    |
| DOT control                           | Included with therapy |
| 2 <sup>nd</sup> WarmTouchShell® BWTS2 | \$                    |

## FEATURES

|                   |         |  |   |
|-------------------|---------|--|---|
| Installation type | Drop-in |  |   |
| No. of bathers    |         | Inverted V                                     | 2 |
| US gallons        | 67      | Armrests                                       | 4 |
| Imp. gallons      | 56      | Grab bars (color match)                        | 2 |
| Raised seats      | 2       | Comfort Cushion (specify color: Grey or Black) | 2 |

## STANDARD COLOR

|          |            |          |
|----------|------------|----------|
|          |            | Included |
| White 01 | Biscuit 02 |          |

## OPTIONS (UPCHARGE APPLICABLE)

### FINISH

|   |    |
|---|----|
| UltraVelour Matte Finish (white only) BVEL1 | \$ |
|---|----|

### CLEAR ACRYLIC GRAB BARS BGBG10-XX

|   |    |
|---|----|
| With Chrome 07 or Brushed Nickel 09 inserts | \$ |
|---|----|

### WASTE & OVERFLOW

16" x 35"  
BOVER16-XX

INTE-GRATED  
BOVERIN-XX

|  |     |     |
|--|-----|-----|
| Chrome 07                              | \$  | \$  |
| White 01, Biscuit 02                   | \$  | \$  |
| Matte White with UltraVelour finish 32 | N/A | \$  |
| Brushed Nickel 09, Polished Nickel 10  | \$  | \$  |
| Oil-rubbed Bronze 11                   | \$  | N/A |
| Matte Black 19, Satin Brass 18         | N/A | \$  |

### IF REQUIRED BY CONSTRUCTION CODE

|   |    |
|---|----|
| Brass waste & overflow kit* BDRCOB                        | \$ |
| Brass waste kit* BDRCB                                    | \$ |
| 16" x 35" Cable driven brass waste & overflow kit BOVERBR | \$ |



Don't forget to specify the deck height (1/2" or 1 1/2"). Faucet must be installed on the deck flat surface.

\* When ordered with integrated waste & overflow.

**TOTAL PRICE** \$



**INUA 7240**



Comfort Cushion (2 included)

**INSTALLATION**

**A** With the AromaCloud®, you must choose to install the control or the faucet on opposite side.

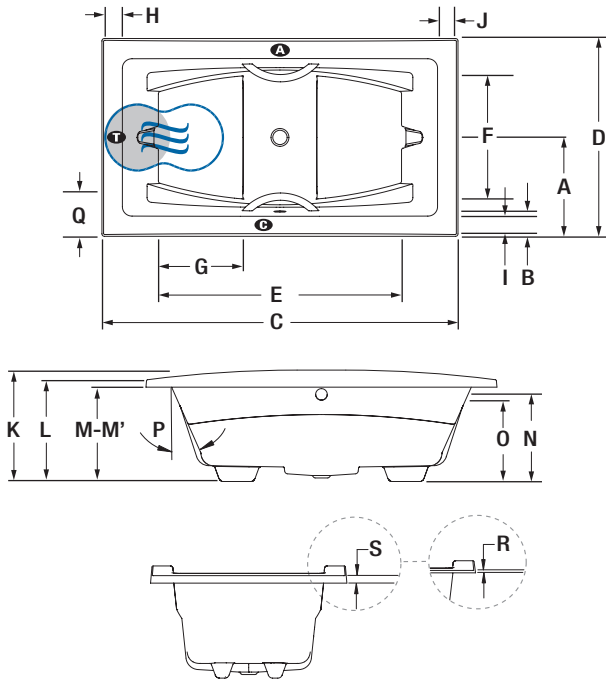

| LETTER | DESCRIPTION   | MEASURE |
|--------|---|---------|
| A      | Outside edge to center drain                          | 20"     |
| B      | Outside edge to overflow                              | 4 1/2"  |
| C      | Total length  | 72"     |
| D      | Total width   | 40"     |
| E      | Bathing well length                                   | 49 1/8" |
| F      | Bathing well width at center zone                     | 25 1/8" |
| G      | Raised seat length                                    | 17 1/8" |
| H      | Deck width at backrest end                            | 4 5/8"  |
| I      | Deck width  | 4 5/8"  |
| J      | Deck width  | 4 5/8"  |
| K      | Height from bottom of bath to top deck                | 23"     |
| L      | Total height to headrest                              | 21"     |
| M      | Height from bottom of bath to bottom of standard deck | 19 1/2" |
| M'     | Height from bottom of bath to bottom of slim deck     | 20 1/2" |
| N      | Height from drain to center of overflow               | 17 1/8" |
| O      | Maximum water level                                   | 15 3/8" |
| P      | Slope of backrests                                    | 24°     |
| Q      | Minimum spout reach                                   | 8 3/4"  |
| R      | Slim deck minimum height                              | 1/2"    |
| S      | Standard deck minimum height                          | 1 1/2"  |

- A** AromaCloud® position
- T** Turbine position (TMU)
- C** Control position when factory-installed (Mia® or DOT)
- Indicates heated backrest (TMU)
- ☄ Indicates WarmTouchShell® position (TUB)

**TECHNICAL SPECIFICATIONS**

|   |  |
|---|--|
| <b>Hot water supply required</b>              | The hot water supply should be 70% or more of the bath's total water capacity.   |
| <b>Turbine</b>                                | Access to the pump must be at least 18" x 22". <b>Standard connection is 20 A, 120 V, 60 Hz</b> , dedicated line with a Ground-Fault Circuit Interrupter (GFCI). <b>For any additional option, a second line is needed 15 A, 120 V, 60 Hz</b> , dedicated line with a GFCI. Air vent necessary: 2" x 4" minimum. |
| <b>Therapeutic Comfort Cushion - INCLUDED</b> | - Made of ultras resistant urethane gel<br>- Extremely comfortable and soft to the touch<br>- Fully waterproof - Remarkably durable - Color available: Grey + Black  |
| <b>Other</b>                                  | - The Geysair is located on the same side as the heated backrest. It must <b>NOT be relocated</b> . It must be <b>connected to the hot water supply</b> and be accessible (provide access).  |

Our products must be installed by certified professionals only and according to our Owner's Manual as well as federal, provincial/state and local building codes and regulations ([www.bainultra.com/documentation/documentation](http://www.bainultra.com/documentation/documentation)).

|                                |          |
|--------------------------------|----------|
| <b>Approx. shipping weight</b> | 153 lbs  |
| <b>Turbine power</b>           | 550 W    |
| <b>Air heater</b>              | 600 W    |
| <b>WARRANTY</b>                |          |
| Controls-LED-Geysair*          | 5 years  |
| Bath & turbine*                | 20 years |

\* Some restrictions apply | [www.bainultra.com/warranty](http://www.bainultra.com/warranty)

The specifications shown indicate the outer edge dimension and the inside bathing capacity dimension measured at air jets' height. The manufacturer accepts a 1/4" [0.64 cm] variance. There are variations on each product and specifications are subject to change as we improve upon our product as required. The dimensions needed for site preparation and structure building will differ. BainUltra® assumes no responsibility for preparatory work done prior to the product being on site.